



# STAINLESS STEEL BUTTON

# EXIT BUTTONS

Market leading stainless steel buttons, that are both hard wearing and cost effective. Suitable for use in applications up to 30V.



**EBSS02/PTE**



**EBSS/AP/PTE**



**EBSS/AP/PTOPEN**

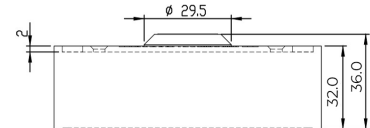

## SPECIFICATION

- EBSS02 / EBSS25 / EBSS/AP
- Contacts: Double pole N/O - N/C
- Output: 4 AMP contact @ 30V AC/DC
- Wear resistant legend
- Security screws (allen key type)
- Internal use
- Button rated IP54 ingress protection
- Silver contacts
- Operating temperature -20° to +60°C
- Operating travel: 2mm
- Contact resistance: 10m OHM (Max)
- Operating life (mechanical): 1,000,000

EBSS02 & EBSS/AP - 22mm Button  
EBSS25 - 25mm Button

## FEATURES

- EBSS02 / EBSS25 / EBSS/AP
- Stainless steel button
- Momentary operation / contact
- High impact plastic back box
- Can be surface or flush fitting
- Easy clean surface
- Ideal for general / sensitive areas
- Screw footprint for flush fitting onto standard back box
- Distance between fixing holes 60mm

- Alternative Text
- Door Release
  - Emergency Running Man Symbol (No Text)
  - Blank (No Text)
  - Arabic

## OTHER PRODUCTS

**EBNT/TF-1**



**EXTR02**



**ML600**



**DU-GB/PTE**



## DIMENSIONS

- EBSS02 / EBSS25
- 85x85x28 (mm)
- 240g (Boxed) • 198g (Unboxed)
- EBSS/AP
- 85x39x28 (mm)
- 128g (Boxed) • 108g (Unboxed)

## CONTENTS

- EBSS02 / EBSS25 / EBSS/AP
- Stainless Steel Exit Button
- Stainless Steel Plate (2mm)
- 2 Security Screws
- Allen Key
- Surface Box

