



ELECTRIC RELEASE

MAGNETIC LOCK



DS-001A

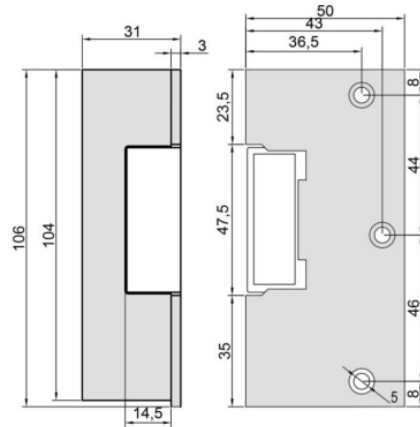

SPECIFICATION

- DS-001A
- Use with access and door entry systems
 - Fail Secure
 - Rim releases suitable for rim night latches fitted on inward opening doors
 - If used with mortice faceplate, suitable for inward or outward opening doors
 - Suits latches with 12mm maximum throw
 - Jaw strength up to 880lbf (362kgf/256N)
 - Operating voltage 12V AC or 12V DC
 - Grey finish

FEATURES

- DS-001A
- Internal use
 - Fail-secure
 - Mortice/Rim face plates included

OTHER PRODUCTS

1201SM-1



KP1000



DIMENSIONS

- DS-001A
- Mortice: 161x25.5 (mm)
 - Rim: 106x50 + 104x31 (mm)
 - 390g Boxed
 - 374g Unboxed

CONTENTS

- DS-001A
- Door Strike
 - Rim Plate
 - Diode

ML600



DU-GB/PTE



Manufactured by a BSIA Member